

Schlebach Quadro

VALLEY

- 1.) Temporarily attach valley trim at ends w/ #10-12 x 1" pancake head wood screws.
- 2.) Apply butyl sealant across top of valley trim as shown.
- 3.) Attach cleat through sealant w/ #10-12 x 1" pancake head wood screws @ 4"oc.
- 4.) Apply a second bead of butyl sealant across the top of the cleat, and over the fastener heads.
- 5.) Install panels so that the cleat is engaged into the field applied hem.

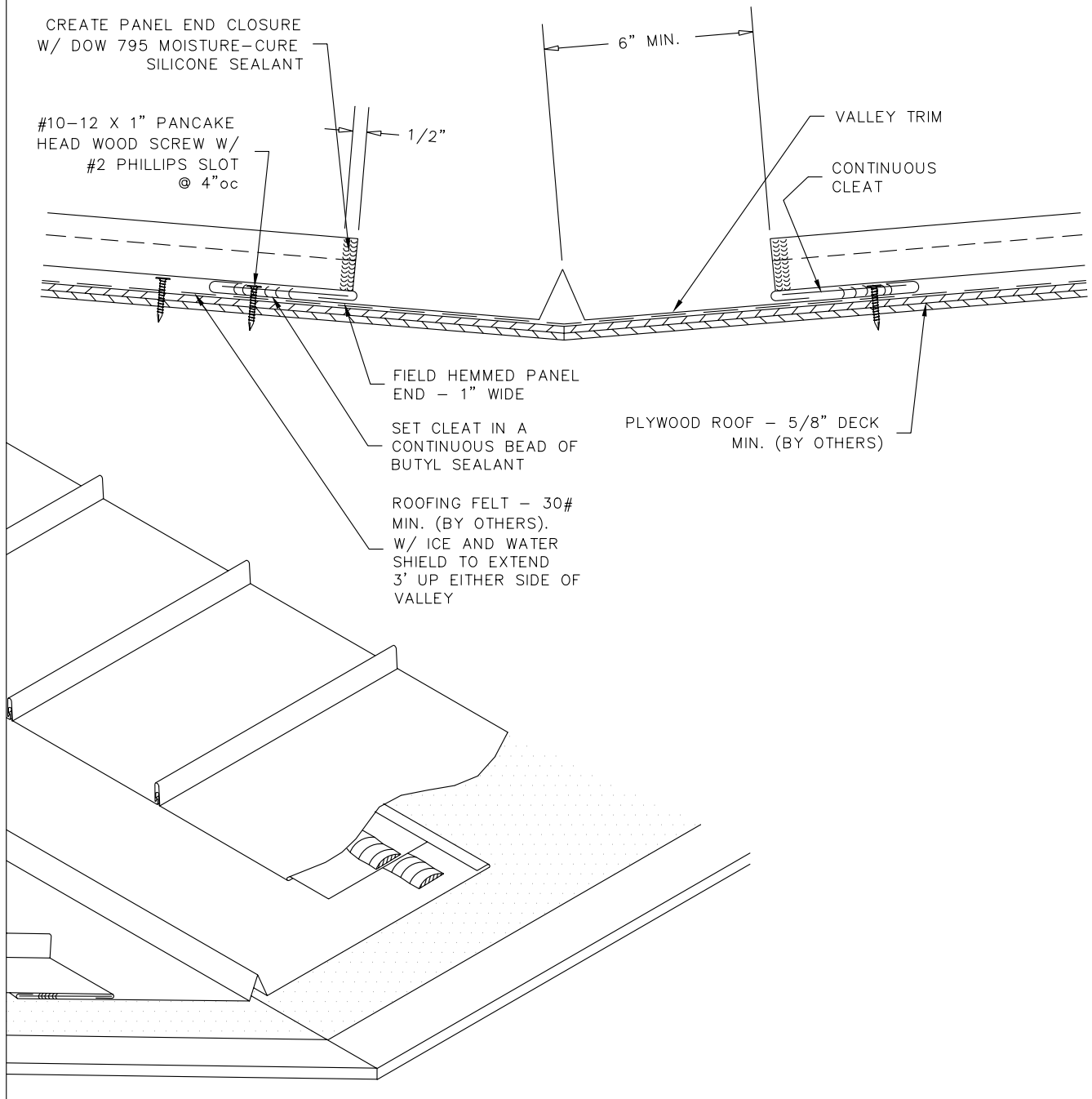

Schlebach Quadro

VALLEY

CREATE PANEL END CLOSURE
W/ DOW 795 MOISTURE-CURED
SILICONE SEALANT

#10 X 12 X 1" PANCAKE
HEAD WOOD SCREW W/
#2 PHILLIPS SLOT
@ 4" oc

1/2"

6" MIN.

VALLEY TRIM

CONTINUOUS
JOGGLE CLEAT

FIELD HEMMED PANEL
END - 1" WIDE

SET CLEAT IN A
CONTINUOUS BEAD OF
BUTYL SEALANT

PLYWOOD ROOF - 5/8" DECK
MIN. (BY OTHERS)

ROOFING FELT - 30#
MIN. (BY OTHERS).
W/ ICE AND WATER
SHIELD TO EXTEND
3' UP EITHER SIDE OF
VALLEY

